



930, 940, 950

QUICK REFERENCE GUIDE

This Quick Reference Guide DOES NOT replace the Operators Manual. You MUST read ALL the disclaimers and safety and other instructions in the Operators Manual before initially operating this product. Accordingly, no legal claims can be entertained based on the data, illustrations or descriptions in this Quick Reference Guide.

BEST PRACTICES

1. Carry a load as low as possible while maintaining good visibility.
2. Forks should be tilted back when in transport – with or without a load, cradle the load.
3. Fork tips should be on the ground when unit is parked.

Static Dimensions

Machine model		930	940	950
A	Overall height	ft-in	8-4	
B	Overall width (over tires)	ft-in	7-2	
C	Overall length to front of carriage	ft-in	11-7	11-9
D	Inside width of cab	ft-in	3-6	
E	Front track	ft-in	5-9	
F	Wheelbase	ft-in	6-9	7-2
G	Ground clearance	ft-in	0-10	
H1	Mast tilt forwards	°	18	22
H2	Mast tilt backwards	°	10	
J	Load center	ft-in	0-21	

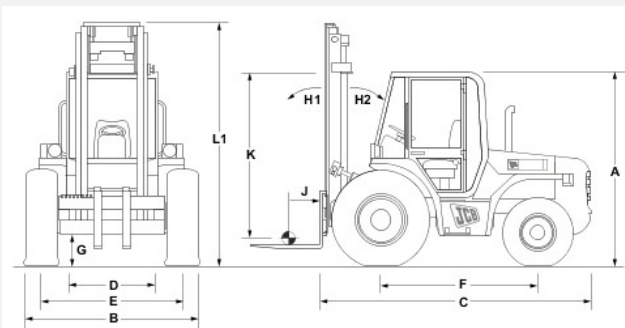

Cab and Switch Panel

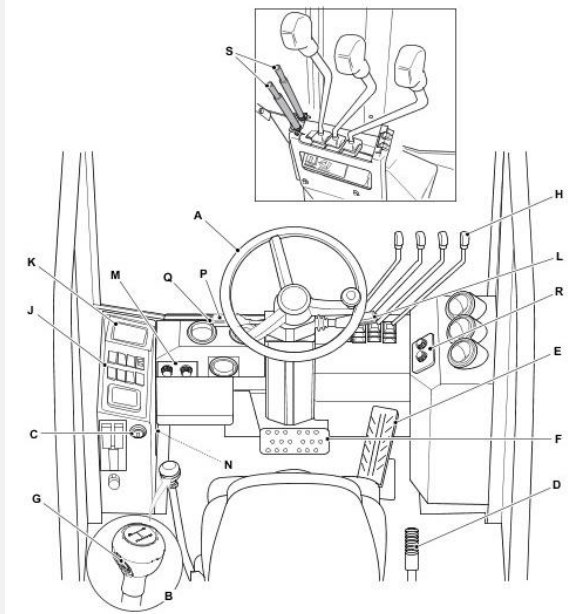

- A. Steering wheel
- B. Gear lever
- C. Starter switch
- D. Park brake lever
- E. Accelerator pedal
- F. Service brake pedal
- G. Transmission dump switch
- H. Mast Control Functions
- J. Console switches
- K. Instrument panel
- L. Multi-Purpose switch
- M. Heater controls
- N. Auxiliary power socket
- P. Drive lever
- Q. Horn
- R. HVAC
- S. Control locks (Optional)

Instrument Panel

- A. Amber warning
- B. Engine oil pressure
- C. Not used
- D. Low fuel
- E. Fuel level
- F. Air filter blocked
- G. Water in fuel warning
- H. Engine coolant temperature
- J. Indicators
- K. Park Brake
- L. Alternator charge
- M. Cold start active
- N. Hour meter/time to service/service due/fault code display
- P. Seat belt
- Q. Critical stop
- R. Main beam
- S. Transmission oil pressure
- T. Transmission oil temperature

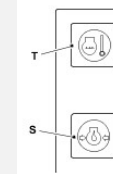
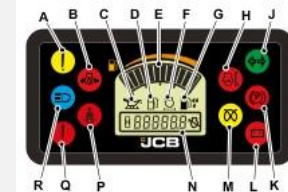

Start Up Sequence

*Operator must be seated for unit to turn on. Standard safety seat will sound alarm if operator gets up while unit is running

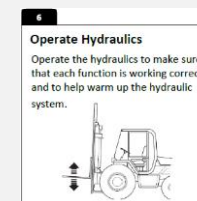
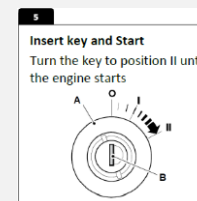
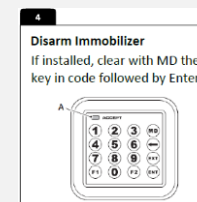
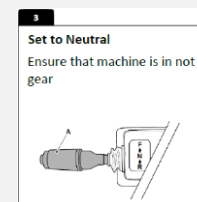
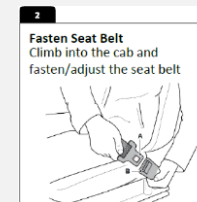
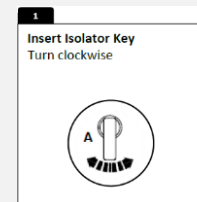

Mast Controls

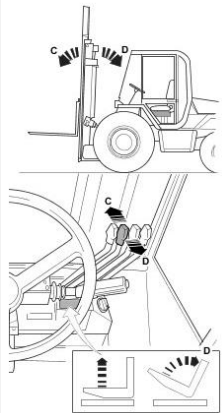
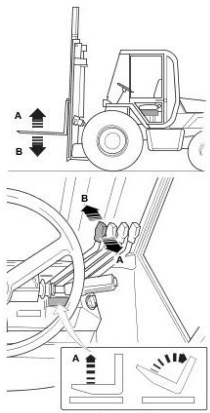

- A. Mast raise
- B. Mast lower
- C. Mast tilt forward
- D. Mast tilt back

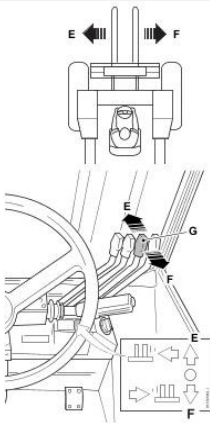

Side-Shift Mast

- E. Left side
- F. Right side
- G. Additional lever

Auxiliary Circuit Controls

- A. Quick release coupling

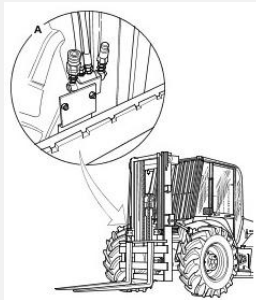

Single Auxiliary (Option)

- B. Lever direction
- C. Lever direction
- D. Additional lever
- E. Additional lever

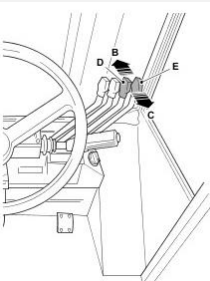

Service Points

Engine Compartment

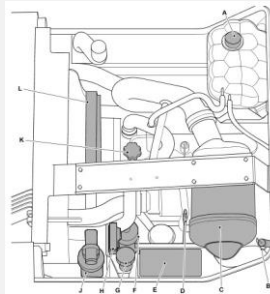

- A. Expansion tank cap
- B. Transmission oil dipstick
- C. Air filter
- D. Engine oil dipstick
- E. Battery
- F. Engine oil filter
- G. Brake fluid tank
- H. Fuses
- J. Fuel filter/water separator
- K. Engine oil filler cap
- L. Radiator

Cab / Exterior

- A. Window washer tank
- B. Hydraulic filler cap
- C. Hydraulic fluid level indicator

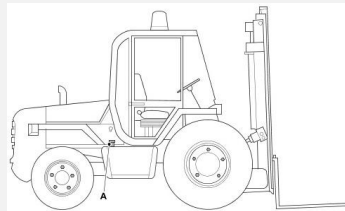
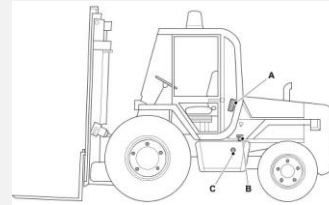

- A. Fuel tank

Access Covers

Engine Compartment Cover

- A. Engine cover
- B. Latches
- C. Handle
- D. Latch – Release first
- E. Latch – Release second

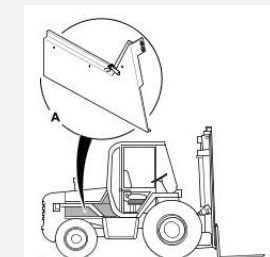
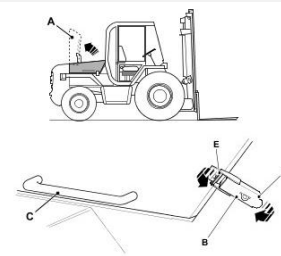

- A. Engine side panel

Mast Grease Points

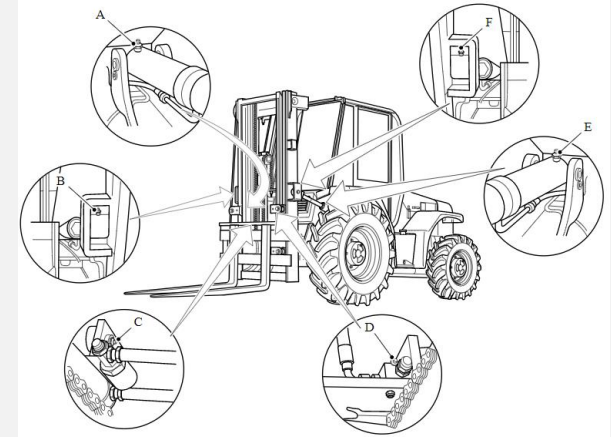

Lifting Point

- A. Lifting point labels

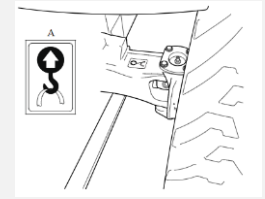

Tie Down Points

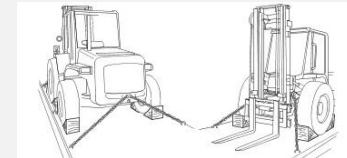

Mast Transport Position

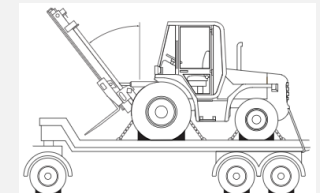
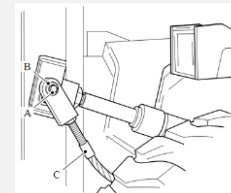

- A. Bolt
- B. Washer
- C. Restraint wire

1. Remove tilt cylinder restraint wires (option)
2. Raise carriage so forks will not touch trailer
3. Tilt the mast fully forward