



Electric TLT

QUICK REFERENCE GUIDE

This Quick Reference Guide DOES NOT replace the Operators Manual. You MUST read ALL the disclaimers and safety and other instructions in the Operators Manual before initially operating this product. Accordingly, no legal claims can be entertained based on the data, illustrations or descriptions in this Quick Reference Guide.

BEST PRACTICES

1. Carry a load as low as possible while maintaining good visibility.
2. Forks should be tilted back when in transport – with or without a load, cradle the load.
3. Fork tips should be on the ground when unit is parked.

Static Dimensions

Machine model	66-40E		
A	Overall length to fork face	ft-in	9-10
B	Overall machine width	ft-in	4-3
C	Standard height of overhead guard	ft-in	7-4
D	Wheelbase	ft-in	5-11
E	Ground clearance at center of wheelbase	ft-in	0-7
F	Ground clearance at lowest point	ft-in	0-6

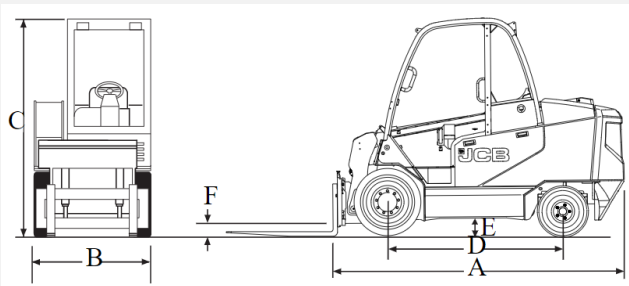

Moving Machine

Lifting Machine



- Lifting point x 4
- Padding

Tie-Down Points



- Securing method

Cab and Switch Panel

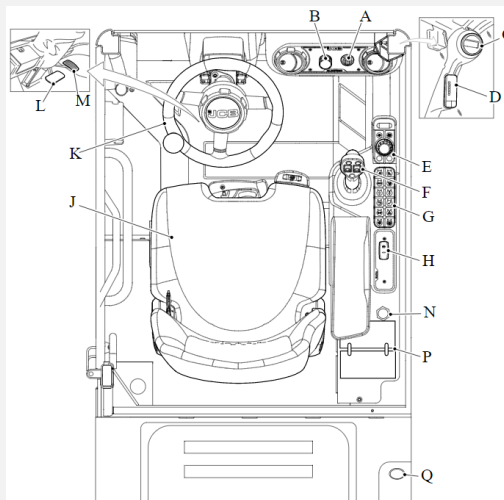

- Ignition switch
- Emergency stop button
- Instrument panel
- LLMI
- Cab heater control
- Lift arm control lever
- Switch console
- Park brake switch
- Seat
- Steering wheel
- Brake pedal
- Accelerator pedal
- Diagnostic connector
- Load chart
- Power socket

Drive Selection Switch

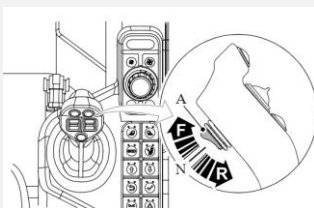

- Drive selection switch
F = Forward
N = Neutral
R = Reverse

Instrument Panel

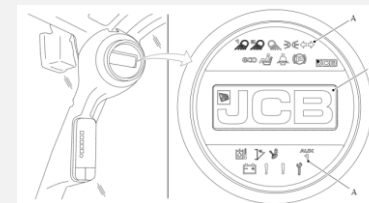

- Warning and notification symbols
- Display screen

Home Screen

- Dynamic information screen
- Battery level status
- Drive selection
- Battery percentage
- Menu navigation

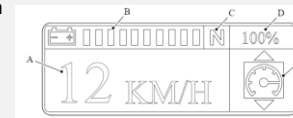

Interlocks Screen



In order for machine to start:

- Operator seated
- Park brake applied
- Machine in neutral

Start Up Sequence

1 Connect the Electrics

With the ignition switched off push the connector on



2 Fasten Seat Belt

Climb into the cab and fasten/adjust the seat belt

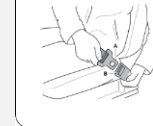

3 Set to Neutral

Ensure the machine is not in gear and the parking brake is on



4 Emergency Stop Button

Ensure that the Emergency Stop Button (B) is not engaged

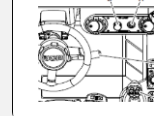

5 Insert Key and Start

Turn the key to position I to connect battery to all the electrical components

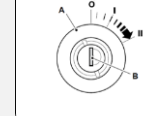

6 Operate Hydraulics

Operate the hydraulics to make sure that each function is working correctly

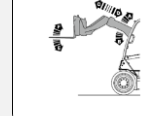

Access additional information

www.servicepro.jcb.com



Single Lever Control

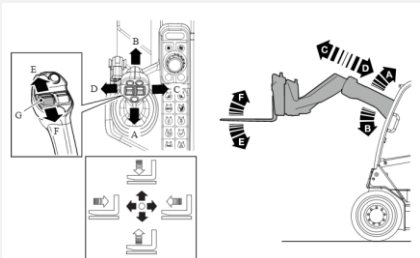

- A. Boom raise
- B. Boom lower
- C. Boom extend
- D. Boom retract
- E. Carriage tilt forward
- F. Carriage tilt back
- G. Carriage tilt roller

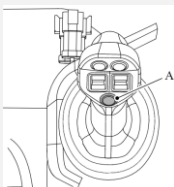

- A. Horn

Auxiliary Circuit Controls

- A. Auxiliary vent
- B. Auxiliary 1/2
- C. Thumb switch

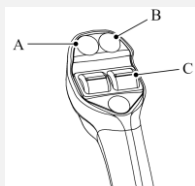

Longitudinal Load Movement Indicator (LLMI)

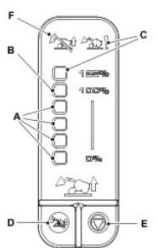

- A. Green colour LED
- B. Amber colour LED
- C. Red colour LED
- D. Override button, White colour LED
- E. Calibrate button, White colour LED / Test button
- F. Amber/Green LED

Service Points

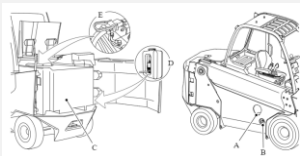

- A. Hydraulic oil filler cap
- B. Hydraulic oil level indicator
- C. Battery
- D. Washer bottle
- E. Battery isolator

Access Covers

Rear Cover

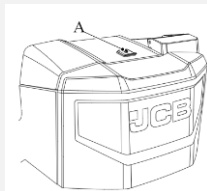

- A. Latch

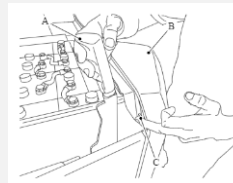

- A. Release handle
- B. Rear cover
- C. Latch

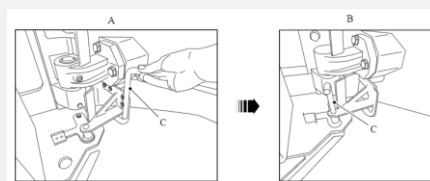

- A. Stowage position
- B. Locking position
- C. Locking pin

To lift cab to access motors and drive components, see manual for details

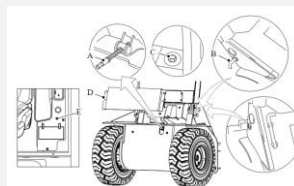

- A. Jack
- B. Tilt lock pin
- C. Cab bolts
- D. Front cover
- E. Cover plate

Battery Replacement/ Maintenance

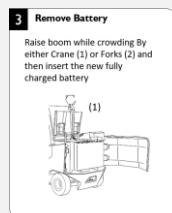
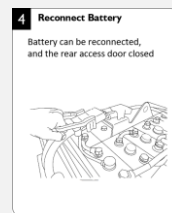
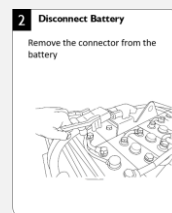
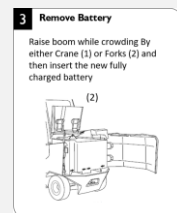

Console Switches

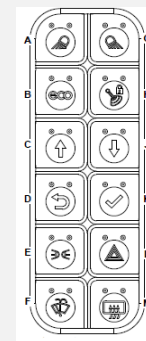

- A. Front work light
 - 1x press = work lights
 - 2x press = extra work lights (option)
- B. Eco mode
 - Eco1 = 90% power
 - Eco2 = 80% power
 - Eco3 = 70% power
- C. Up (in display)
- D. Back (in display)
- E. Side lights
- F. Front windshield wiper
- G. Rear work light
- H. Joystick isolation/lock out
- J. Down (in display)
- K. Select
- L. Hazard warning
- M. Rear heated screen

Install Fork Attachment

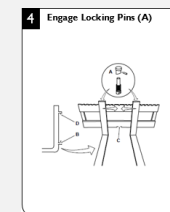
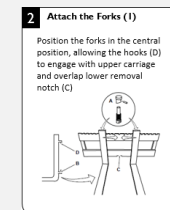
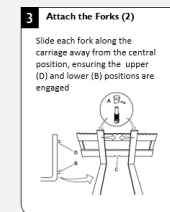

Install Bucket Attachment

