



SCISSOR LIFTS

QUICK REFERENCE GUIDE

This Quick Reference Guide DOES NOT replace the Operators Manual. You MUST read ALL the disclaimers and safety and other instructions in the Operators Manual before initially operating this product. Accordingly, no legal claims can be entertained based on the data, illustrations or descriptions in this Quick Reference Guide.

Static Dimensions

Machine model	S1530E	S1930E	S2032E	S2046E	S2632E
Maximum platform height	ft-in 14-11	19	20	26	26
Maximum working height	ft-in 21-6	25-6	27-2	27-2	33-1
Platform size (L x W x H)	ft-in 5-3 x 2-5 x 3-6		7-3 x 2-6 x 3-6	7-3 x 3-7 x 3-6	7-3 x 2-6 x 3-6
Ground clearance	ft-in 4-3	0-2		0-3	
Wheelbase	ft-in 4-3		5		6
Extension Outreach	ft-in 3		5		2-9
Overall length (stowed)	ft-in 5-8		7-8	7-8	7-8
Overall width (stowed)	ft-in 2-5		2-6	3-7	2-6
Overall height (stowed, guardrail folded)	ft-in 6	6-1		6	6-4
Overall height (stowed, guardrail unfolded)	ft-in 6-8	6-9		7-2	7-7

Machine model	S2646E	S3246E	S4046E	S4550E
Maximum platform height	ft-in 26	32	39	45
Maximum working height	ft-in 33-1	39-3	45-6	51-8
Platform size (L x W x H)	ft-in 7-3 x 3-7 x 3-6		8-6 x 2-6 x 3-6	
Ground clearance	ft-in 6		0-3	
Wheelbase	ft-in 6		7-3	
Extension Outreach	ft-in 3		2-9	
Overall length (stowed)	ft-in 7-8		9	
Overall width (stowed)	ft-in 3-7		4-1	
Overall height (stowed, guardrail folded)	ft-in 6-4	6-1	6-4	7-2
Overall height (stowed, guardrail unfolded)	ft-in 7-7	8-1		8-5

Charge Level and Charging

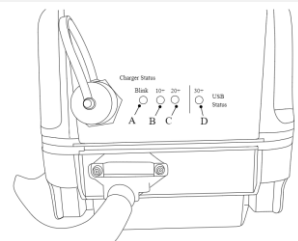

- A. 50%
- B. 70%
- C. 100%
- D. USB status

If A, B, and C are blinking together, see Manual for fault indicator

Tie Down Points

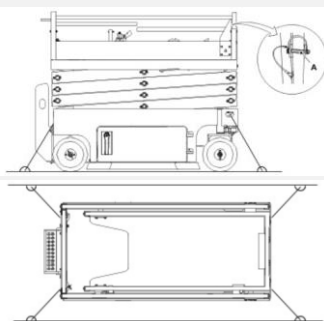

- A. Lock pins
1. If required, remove lock pins from all four corners of platform and fold down guardrails.
 2. Use tie down points to secure machine

Main Components

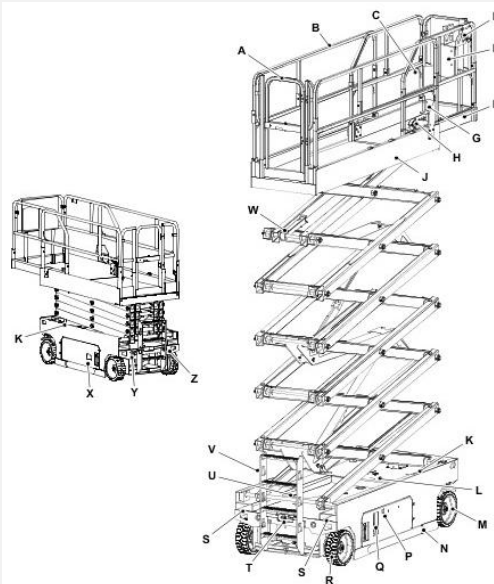

- A. Gate
- B. Guardrail
- C. Harness fastening point
- D. Platform control panel
- E. Operator's Manual
- F. Platform extension
- G. AC (Alternating Current) Power socket (option)
- H. Extension platform pedal
- J. Main platform
- K. Warning lights
- L. Tilt sensor
- M. Front wheel (steering)
- N. Pot hole protection plate
- P. MECU (Machine Electronic Control Unit) display
- Q. Ground controller
- R. Rear wheel
- S. Lift point/ forklift position
- T. Manual release valve and emergency lowering handle
- U. Pot hole activation plungers
- V. Ladder
- W. Safety strut
- X. Battery charger
- Y. Charging plug
- Z. Power to platform plus

Platform Controller

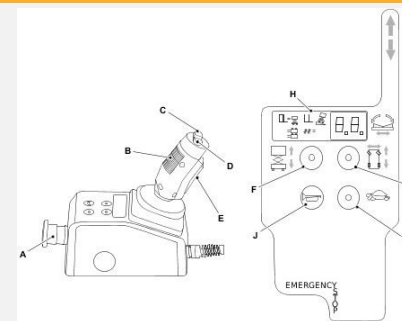

- A. Emergency stop switch
- B. Joystick (forwards/backwards)
- C. Turn left switch
- D. Turn right switch
- E. Safety trigger/enable switch
- F. Raise/lower mode
- G. Drive mode
- H. Display
- J. Horn button
- K. Speed button

Ground Control

- A. Ground control position
- B. Platform control position
- C. Key switch
- D. Platform raising/lowering toggle switch
- E. Emergency stop switch
- F. Hourmeter

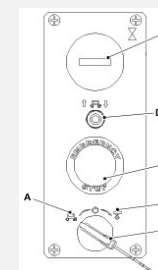

Start Up Sequence

- 1 Connect Isolator**
 The isolator is located within the battery tray on the left hand side of the machine.
- 2 Pull E-Stops**
 Ensure both the ground controls and platform controls E-stops are released.
- 3 Switch Key Right**
 Turn the key switch right to enable the platform controls.
- 4 Mode Select**
 Choose from either lift/lower or drive mode. Do not attempt to operate prior to charge status being shown.
- 5 Trigger & Joystick**
 Pull the trigger on the back of the joystick to enable operation.



Extending and Retracting Platform

- A. Pedal
- B. Fixing positions

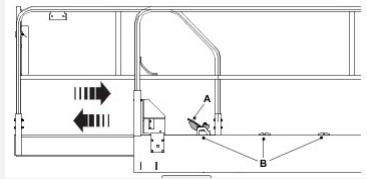

1. Press the pedal.
2. Hold and push the extension platform guard rail.
3. Release the pedal when the rail is in one of the three fixing positions. Make sure that it is engaged correctly.
4. Press the pedal and pull the extended guardrail to retract the platform

Driving on Slopes

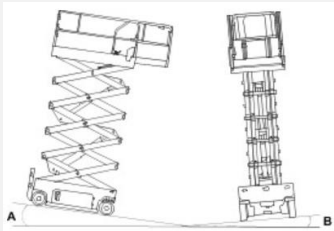

Do not Exceed slopes when platform is raised:

- A. Front/back slope 3°
- B. Side slope 1.5°

Folding and Unfolding Guardrails

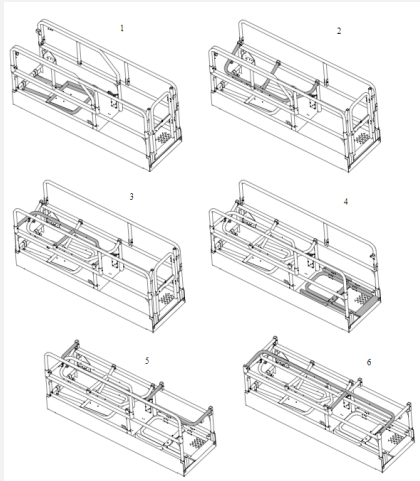

1. To fold down each guardrail, remove the lock pin for that guardrail.
2. Take a firm hold on the top of the guardrail, carefully lower it until it is fully folded.

Service Points

Hydraulic Compartment

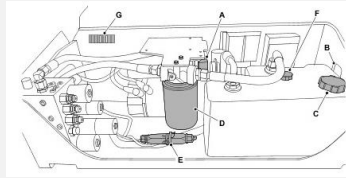

- A. Main control relay
- B. Hydraulic oil level indicator sight hole
- C. Hydraulic oil filter cap
- D. Hydraulic oil filter
- E. Platform control connection
- F. Hydraulic breather
- G. Secondary fuses

Battery Compartment

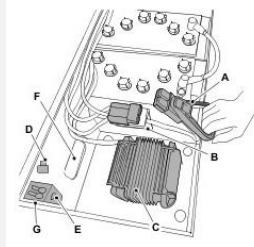

Lead Acid Battery

- A. Battery isolator
- B. Primary fuses (275 A rating)
- C. Battery Charger
- D. Primary fuse (20 A rating)
- E. DC contactor resistor
- F. Battery charger status sight hole
- G. DC contactor

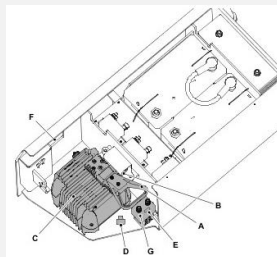

Lithium Iron Phosphate Battery

- A. Battery isolator
- B. Primary fuses (275 A rating)
- C. Battery Charger
- D. Primary fuse (20 A rating)
- E. DC contactor resistor
- F. Battery charger status sight hole
- G. DC contactor

Access Covers

Battery Cover

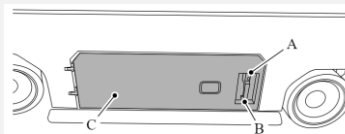

- A. Lock
- B. Handle
- C. Cover

Hydraulic Compartment Cover

- A. Lock
- B. Handle
- C. Cover

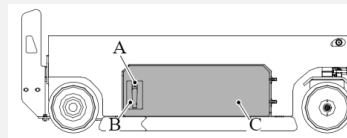

Lower the Platform (Emergency Operation)

- A. Emergency lowering lever



If the machine becomes disabled, platform can still be lowered by pulling on emergency lever

Brake Release

1. Put blocks at front and rear of all four wheels.
2. Release valve is at back of chassis.
3. Push black brake release handle.
4. Firmly pump red brake release handle.
5. Pull the black handle out after the machine is recovered to re-apply the brakes.

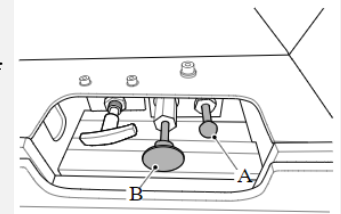

- A. Black brake release handle
- B. Red brake release handle

Lifting by Forklift

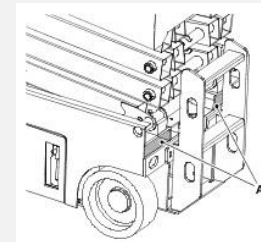

- A. Forklift slots

Lifting by Hoist

Center of Gravity Location

Machine model		X	Y
S1530E	ft-in	2	1-8
S1930E	ft-in	2	1-9
S2032E	ft-in	3-2	2-1
S2632E	ft-in	3-2	2-2
S2046E	ft-in	2-8	1-9
S2646E	ft-in	2-8	1-10
S3246E	ft-in	2-8	2-1
S4046E	ft-in	2-8	2-3
S4550E	ft-in	3-6	2-6

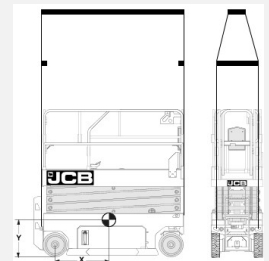

- X. X axis distance
- Y. Y axis distance