



AJ48D Articulated Boom Lift

QUICK REFERENCE GUIDE

This Quick Reference Guide DOES NOT replace the Operators Manual. You MUST read ALL the disclaimers and safety and other instructions in the Operators Manual before initially operating this product. Accordingly, no legal claims can be entertained based on the data, illustrations or descriptions in this Quick Reference Guide.

Static Dimensions

Machine Model		AJ48D
Maximum Platform Height	ft-in	43-3
Maximum Working Height	ft-in	54-3
Maximum Outreach	ft-in	27-3
Maximum Up and Over Height	ft-in	23-7
Jib Length	ft-in	6-0
Platform Length	ft-in	3-7
Platform Width	ft-in	6-0
Platform Height	ft-in	3-7
Overall Length (Stowed)	ft-in	24-1
Overall Width (Stowed)	ft-in	7-5
Overall Height (Stowed)	ft-in	7-4
Ground Clearance	ft-in	1-0
Wheelbase	ft-in	6-8
Overall Weight	lbs	16,317

Main Components

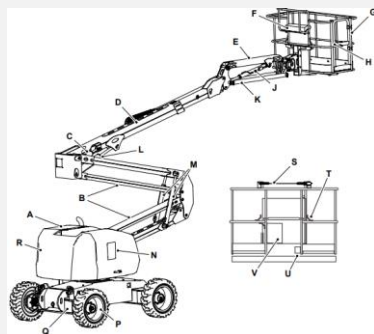

- | | |
|----------------------------------|-----------------------------------|
| A. Hood/Cover | M. Articulated boom lift cylinder |
| B. Articulated boom | N. Base Controller |
| C. Lower leveling cylinder | P. Ram hub steer wheel |
| D. Telescopic extension boom | Q. Front axle |
| E. Jib | R. Counterweight |
| F. Platform controller | S. Crush protection system |
| G. Platform | T. Safety belt anchorage point |
| H. Platform entry gate | U. Foot pedal switch |
| J. Jib lift cylinder | V. Operator manual's case |
| K. Jib level arm | |
| L. Telescopic boom lift cylinder | |

Platform Controls

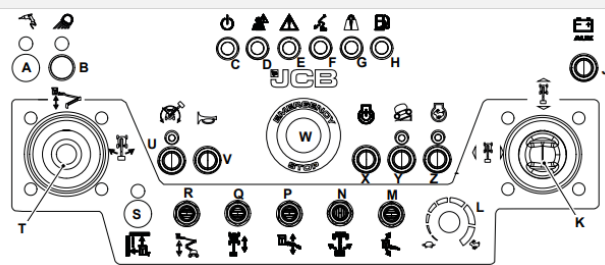

- | | |
|---|---|
| A. Hydraulic generator on/off button | N. Platform rotate switch |
| B. Working light on/off button | P. Jib boom up/down switch |
| C. Power on/off indicator | Q. Toggle switch for drive and steer functions |
| D. Operator error/caution alarm | R. Articulated boom up/down function switch |
| E. Error indicator | S. Platform height restriction |
| F. Tilt limit warning indicator | T. Dual axis proportional control handle for telescopic boom up/down and machine slew functions |
| G. Overload warning indicator | U. Drive enable switch |
| H. Low fuel level | V. Horn switch |
| J. Auxiliary power on/off button | W. Emergency stop button |
| K. Dual axis proportional control handle for drive and steer function | X. Engine stop/ start switch |
| L. Engine idle (rpm) select switch | Y. High torque switch |
| M. Manual platform level switch | Z. Engine high speed switch |

Ground Control

- | |
|--|
| A. Display Screen |
| B. Ignition switch |
| C. Red emergency stop button |
| D. Horn |
| E. Engine stop/ start switch |
| F. Emergency operation switch |
| G. Base control enable switch |
| H. Telescopic boom rise/lower function switch |
| J. Main boom extend/retract switch |
| K. Jib level switch |
| L. Jib rise/lower switch |
| M. Jib extend/retract switch |
| N. Articulated boom rise/lower function switch |
| P. Slew left/right switch |

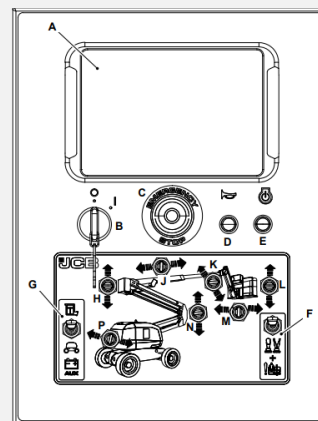

Display Screen

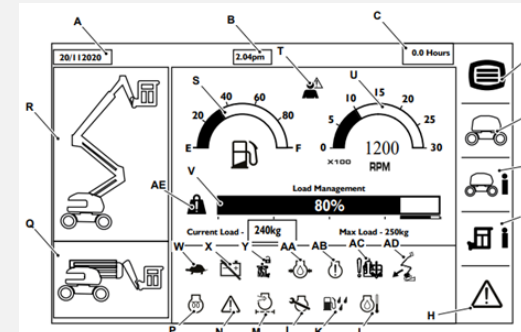

- | | |
|----------------------------|------------------------------------|
| A. Date | S. Fuel level indicator |
| B. Time | T. Operator error or caution alarm |
| C. Machine hour | U. Engine speed indicator |
| D. Display settings | V. Load management indicator |
| E. Machine settings | W. Travel speed |
| F. Base information | X. Alternator lamp |
| G. Platform information | Y. Secondary guarding |
| H. Faults | AA. Engine oil pressure |
| K. Water in fuel | AB. Engine warning lamp |
| L. Service lamp | AC. Emergency mode used |
| M. Blocked air filter | AD. Tilt limit exceeded |
| N. Fault indicator | AE. Overload lamp |
| P. Engine pre-heater | |
| Q. Machine stowed position | |
| R. Machine raised position | |

Tie Down Points

Base Tie Down Points

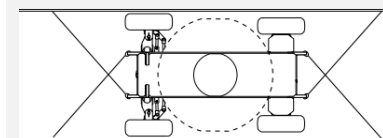

Platform Tie Down Points

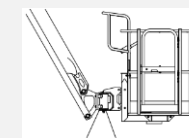

Start Up Sequence

1. Make sure the battery isolator is engaged.
2. Pull out both the base and platform emergency stop buttons.
3. Turn the key to position "I" and let the display system run through the system checks.
4. Press and hold the "Engine Start/Stop" button until the engine is idling.



Access additional information

www.servicepro.jcb.com



Driving on Slopes

Lowered Platform

Do not Exceed slopes when platform is raised:

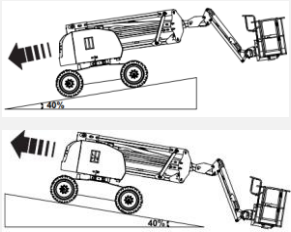

- A. Front/back slope 40°
- B. Side slope 14°

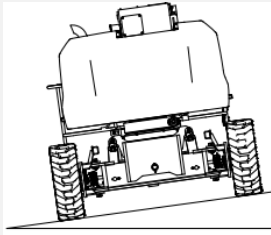

Raised Platform

Do not Exceed slopes when platform is raised:

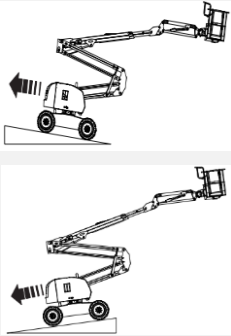

- A. Front/back slope 40°
- B. Side slope 14°

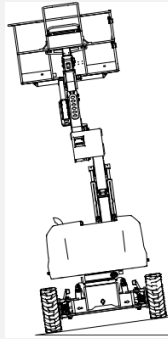

Decal Descriptions

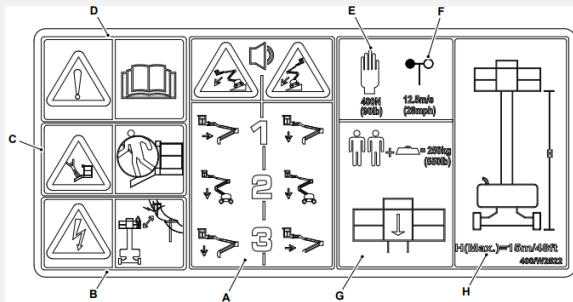

- A. Warning. Stability hazard.
- B. Warning. Keep a safe distance from the overhead electrical cables.
- C. Warning. Do not exit the platform at height. Do not walk or climb on the booms.
- D. Warning. Read operator's manual before operating the machine.
- E. Maximum manual force
- F. Maximum wind speed
- G. Weight distribution on the platform
- H. Maximum platform height

Service Points

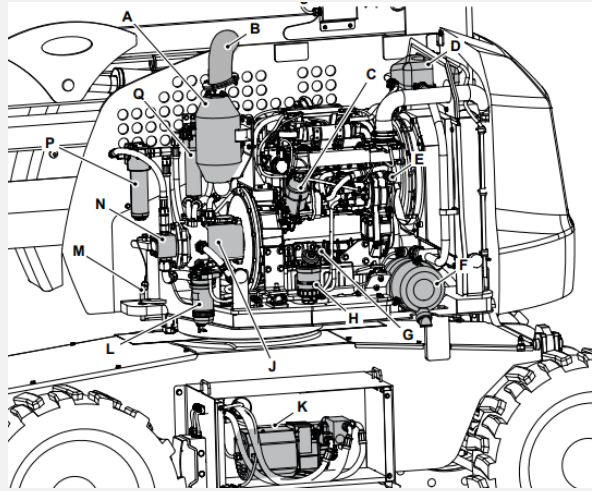

- A. Engine exhaust
- B. Exhaust outlet pipe
- C. Oil filter
- D. Coolant expansion bottle
- E. Oil filler
- F. Air cleaner
- G. Dipstick
- H. Engine fuel filter
- J. Hydraulic transmission pump
- K. Hydraulic generator
- L. Pre filter
- M. Locking pin
- N. Hydraulic boom pump
- P. Hydraulic high pressure filter
- Q. Charge pump filter

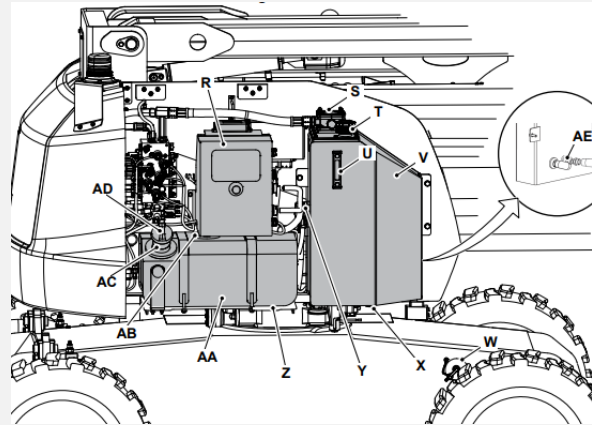

- R. Base control panel
- S. Return line filter
- T. Filler breather
- U. Level gauge/ oil temperature
- V. Hydraulic tank
- W. Battery isolator
- X. Hydraulic tank drain plug
- Y. Hydraulic fittings
- Z. Fuel tank drain plug
- AA. Fuel tank
- AB. Fuel sender
- AC. Fuel filler
- AD. Fuel filler cap
- AE. Suction strainer

Access Covers

Battery Cover

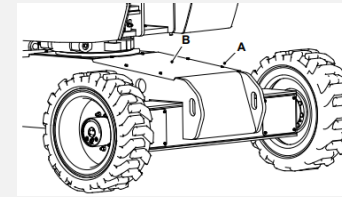

- A. Bolt
- B. Cover

Hydraulic Compartment Cover

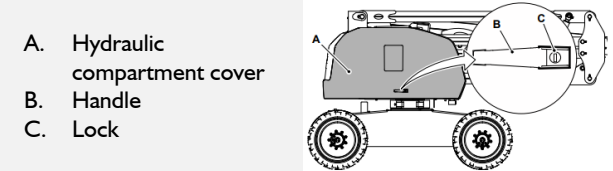

- A. Hydraulic compartment cover
- B. Handle
- C. Lock

Engine Compartment Cover

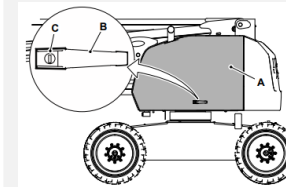

- A. Engine compartment cover
- B. Handle
- C. Lock

Maintenance Position

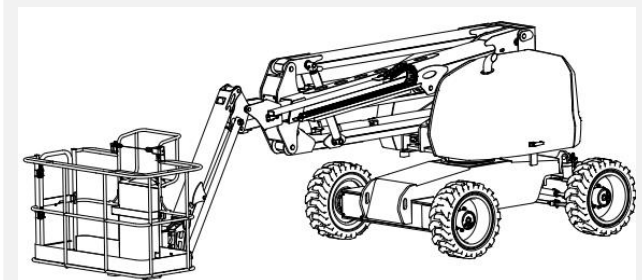

Make the machine safe before you start the maintenance procedure.

1. Park the machine on level, solid (slabbed/paved) ground.
2. Remove the machine key switch.
3. Disconnect the battery to prevent accidental operation.
4. Put the chocks at the front and rear of all wheels.
5. Make sure that machine is in stowed position