



# 85Z-2

## QUICK REFERENCE GUIDE

This Quick Reference Guide DOES NOT replace the Operators Manual. You MUST read ALL the disclaimers and safety and other instructions in the Operators Manual before initially operating this product. Accordingly, no legal claims can be entertained based on the data, illustrations or descriptions in this Quick Reference Guide.

### Static Dimensions

Machine model	85z-2	
A Sprocket idler centers	ft-in	7-6
B Track length on ground	ft-in	7-6
C Undercarriage overall length - rubber	ft-in	9-6
Undercarriage overall length - steel	ft-in	9-5
D Kingpost clearance	ft-in	2-6
E Tailswing radius	ft-in	3-7
F Overall width of superstructure	ft-in	7-1
G Height over cab	ft-in	8-8
H Ground clearance	ft-in	1-1
J Track gage	ft-in	6-0
K Width over tracks (450 shoes)	ft-in	7-5
L Transport length with standard dipper	ft-in	19-1
M Transport height with standard dipper	ft-in	8-8
N Track height	ft-in	2-1
P Counterweight clearance	ft-in	2-5
Operating Weight	lbs	18,408.41

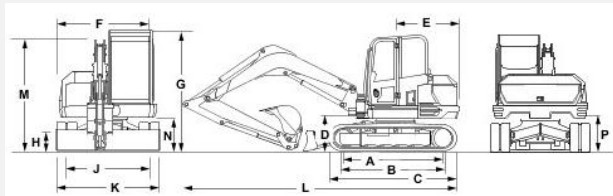

### Tie Down Points

- A. Rear Track Tie-Down
- B. Front Track Tie-Down
- C. Rear Angle
- D. Front Angle

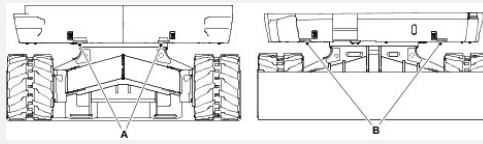
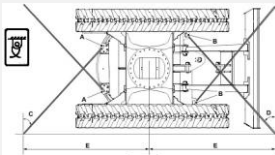

### Cab and Switch Panel

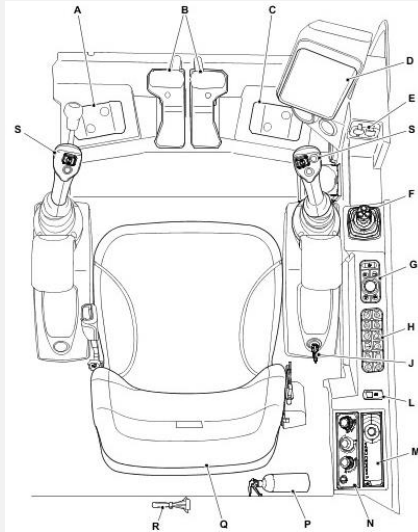

- A. TAB (Triple articulated boom) pedal (option)
- B. Track controls
- C. Foot rest (option)
- D. Instrument panel
- E. 12v socket and USB connector
- F. Dozer blade control lever
- G. Rotary control
- H. Switch console
- J. Ignition key switch
- L. Engine stop switch
- M. Entertainment system
- N. HVAC
- P. Fire extinguisher (option)
- Q. Operator seat
- R. Glazing Breaker
- S. Excavator controls

### Instrument Panel

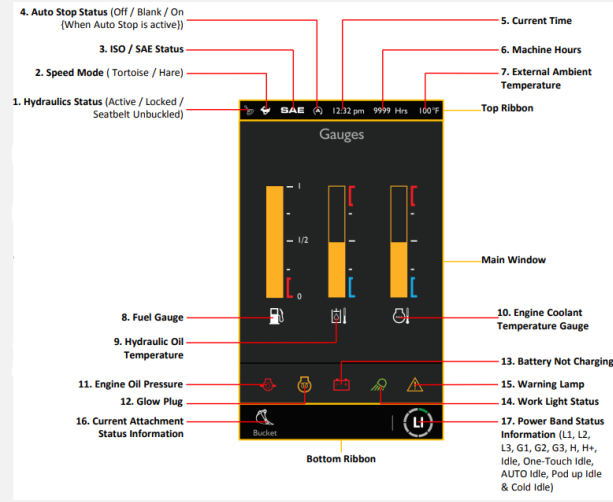

### Instrument Panel

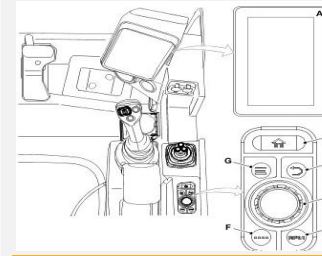

- A. Display
- B. Home button
- C. Back button
- D. Rotary control
- E. Display Engine/Speed Mode
- F. Dynamic Menu
- G. Menu Button

### Drive Controls

#### Tracking Controls

- L. Machine forward
- M. Machine reverse

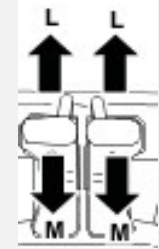

### Start Up Sequence

- 1 Insert Isolator Key**  
 Insert isolator key (A) and turn in a clockwise direction.
- 2 Raise LH Arm Rest**  
 Ensure the hydraulic isolation lever (left hand arm rest) is in the raised position.
- 3 Engage Seat Belt**  
 Engage seat belt (A) into latch (B) before starting machine.
- 4 Engine Pre Heat**  
 Turn ignition to position 1 (A) to pre-heat engine before start. Wait until pre-heat symbol (B) on instrument panel goes off.
- 5 Disarm Immobiliser**  
 If fitted disarm by entering 4-digit PIN code then push ENT button.
 The LED will come on for 3 seconds.
- 6 Start Machine**  
 From ignition position 1 turn ignition to position 3 (A) to start the machine.
- 7 Lower LH Arm Rest**  
 Lower the LH arm rest to activate the hydraulics.
 Note: If 2 GO enabled go to step 8, if not go to step 9
- 8 Press 2 GO Button**  
 If enabled press 2 GO button (A) to activate hydraulics. Instrument panel will illuminate (B) when active.
- 9 Operate Machine**  
 All controls are now active and the machine is now ready to use.



## Excavator controls

### Excavator Levers (SAE)

- A. Dipper in
- B. Dipper out
- C. Raise boom
- D. Lower boom
- E. Crowd bucket
- F. Dump bucket
- G. Slew cab left
- H. Slew cab right
- J. TAB (triple articulated boom)
- K. Footrest (option)
- L. Tracking
- M. Tracking

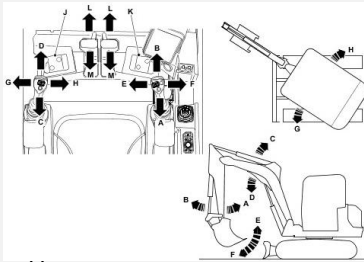

### Swing Control Switch

### Tab Pedal

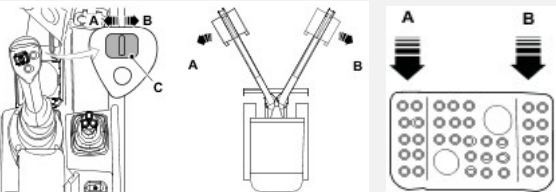

- A. Swing left
- B. Swing right
- C. Swing control switch

- A. TAB boom in
- B. TAB boom out

### Dozer Blade Controls

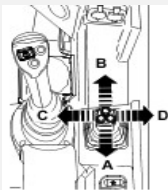

- A. Raise the dozer
- B. Lower the dozer
- C. Angle the dozer (pulling left side in)
- D. Angle the dozer (pulling right side in)

### Auxiliary Circuit Controls

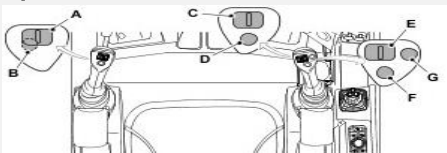

- A. Left electro-proportional switch for aux 2 (low flow)
- B. Tilt/grab changeover for tilt-rotator
- C. Right electro-proportional switch underside (swing)
- D. Right finger button- Full/high flow
- E. Right electro-proportional switch for aux 1 (high flow)
- F. Left finger button – Horn
- G. Right finger button – Engine speed down (one touch idle)

## Service Points

### Hydraulic Compartment

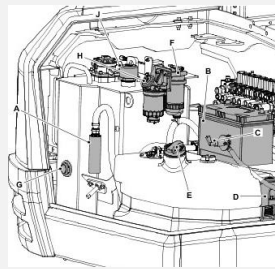

- A. Refueling pump
- B. Battery
- C. Battery isolator
- D. Washer bottle
- E. Fuel filler cap
- F. Main Fuel filter
- G. Hydraulic oil level indicator
- H. Engine fuel filter
- J. Hydraulic oil filler cap

### Engine Compartment

- K. Cool expansion bottle
- L. Radiator
- M. Engine oil filler cap
- N. Exhaust
- P. Engine oil dipstick
- Q. Air filter

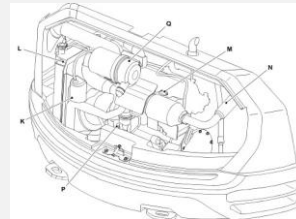

### Tracks

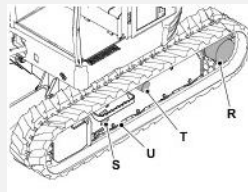

- R. Track gearbox
- S. Track tensioner
- T. Track roller top
- U. Track roller bottom

## Access Covers

### Engine Compartment Cover

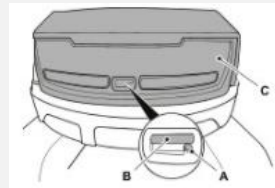

- A. Lock
- B. Handle
- C. Engine compartment cover

### Hydraulic Compartment Cover

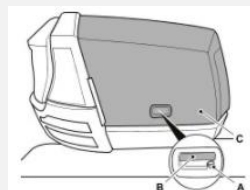

- A. Lock
- B. Handle
- C. Hydraulic compartment cover

## Hydraulic Hitch Unlock Sequence

### 1 Start Unlock Process

To start quick hitch unlock process ensure hydraulics are live then press quick hitch sequence button (A).



### 2 Confirm Process

Instrument panel will indicate need to confirm process (A). To confirm process press 2 GO button (B).



### 3 Boom LED Indicator

When the sequence is confirmed the LED on the boom will flash red (A).

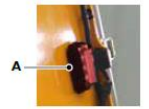

### 4 Remove Attachment

To disengage the pivot pin, crowd attachment for 3 seconds then remove attachment.



### 5 Change Attachment

Operate the machine to engage the jaw (A) with the attachment (B) and then full crowd the attachment to align latch.



### 6 Lock Quick Hitch

To engage the lock on the quick hitch press one of the following two buttons and visually check hitch is locked.

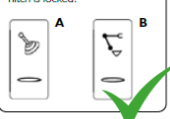

## ISO/SAE

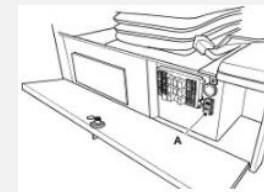

- A. SAE Switch

## Lifting Points

- A. Boom Lift Point
- B. Dozer Blade Lift Point

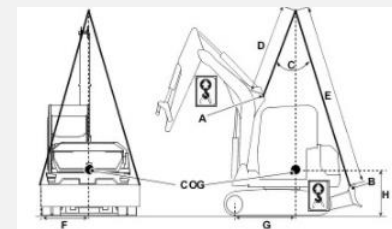

\*COG = Center of Gravity

Item	85Z-2	86C-2 (Monoboom)	86C-2 (TAB)
C	30°	30°	25°
D	9'	7'5"	7'4"
E	17'4"	17'3"	17'5"
F	3'5"	3'5"	3'5"
G	3'2"	3'8"	3'9"
H	3'	4'7"	3'8"